

ScanLogic L68

SecuRam. Reliable. Innovative. Trusted.



FPC-0601A-L68 EntryPad



EL-0601
SwingBolt Lock Body

Works with these Lock Bodies also:



DeadBolt



SpringBolt



StrikeBolt

ScanLogic L68 – Biometric Safe Lock

The ScanLogic L68 is a very reliable and robust biometric safe lock system ideal for commercial applications.

The ScanLogic L68 features SecuRam's rugged stainless steel construction, optical fingerprint authentication and Live Audit Streaming across your network for real-time updates.

Simple to Use. Reliable.

- Place your registered finger on the optical reader and turn the safe handle. That's it.
- Easy fingerprint enrollment process; Open with fingerprint and/or code.
- ScanLogic L68 supports 30 fingerprints and 30 codes plus a 500 event date and time stamped audit trail.
- Every SecuRam lock undergoes a **2,000 cycle** quality management program before it leaves the manufacturing facility. Unprecedented commitment to quality and reliability.

Features

- Supports 30 fingerprints with our patented OneTouch fingerprint verification – 6 digit codes
- TimeLock and Holiday Scheduling
- Set ID01 to Master to establish hierarchical management
- 500 event date and time stamped audit trail
- Wireless Audit Download & Live Audit Streaming
- Programmable Time Delay 0-99 minutes; 0-15 minute Time Window
- Time Delay Override Codes – selectable
- Duress Time Delay allows you to program the Time Delay value when under duress operation
- Recovery Code
- Single or Dual Modes
- Enable / Disable User Codes
- Can Control up to 4 locks and authorize user access for each lock
- Standard footprint and mounting pattern, easy retrofit for any mechanical or electronic safe lock
- SureLock Battery Management and AC power optional
- Finishes available: Chrome, Brass, Black Chrome, Nickel
- Can be paired with any other SecuRam motorized safe lock bodies.

Part#: FPC-0601A-L68-II

Select your Lock Body:

SwingBolt	EL-0601
DeadBolt	EL-0701
SpringBolt	EL-0801
StrikeBolt	EL-0901

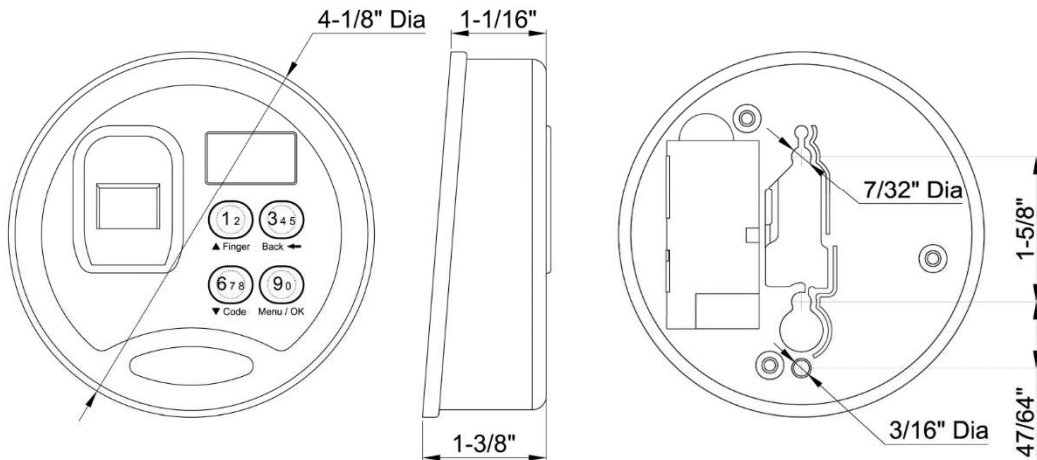

ScanLogic Part # FPC-0601A

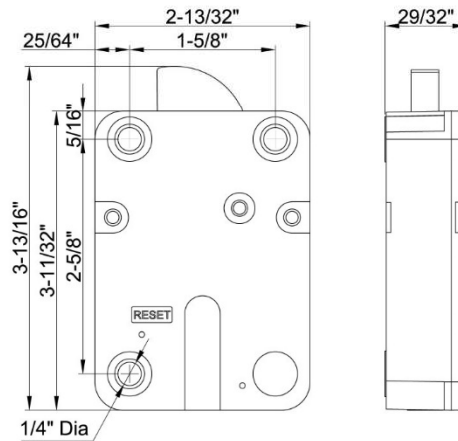

SwingBolt

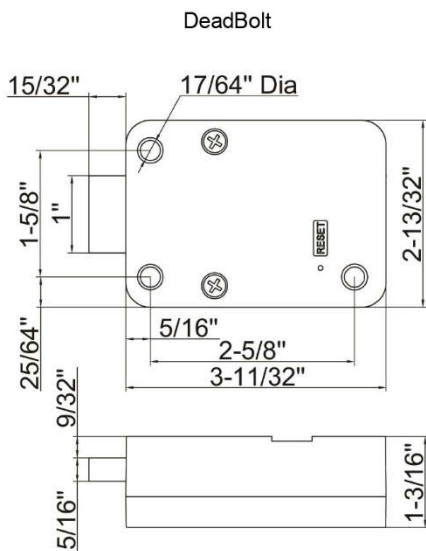

DeadBolt

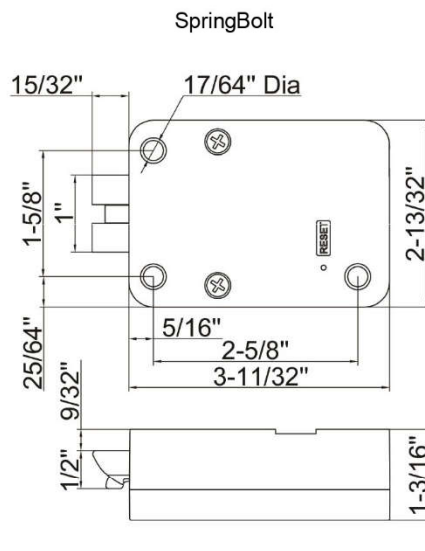

SpringBolt

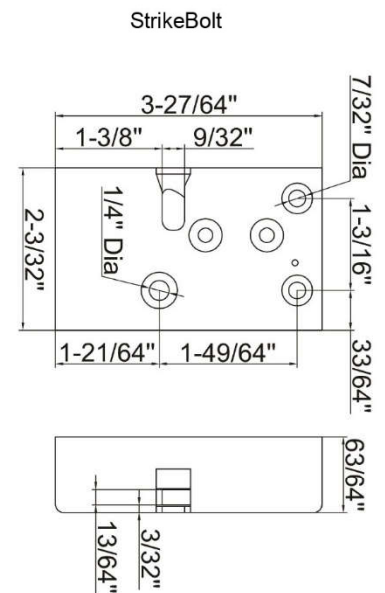

StrikeBolt

Specifications:

Registration Capacity	30 fingerprints + 30 passwords	Temperature Range	-4° F ~ 158° F (-20° C ~ 70° C)
Verification Time	< 1 second	False Acceptance Rate (FAR)	< 0.0001%
False Rejection Rate (FRR)	< 0.1%	Power Supply	(1) 9V Alkaline battery (Duracell)
Standby Current	< 50µA	Battery Life Span	2000~3000 operations
Operating Humidity	90% Maximum	Battery Low Voltage	5.4 ± 0.2V