

ScanLogic Optical

SecuRam. Reliable. Innovative. Trusted.



FPC-0601A Entrypad
Polished Chrome



EL-0601
SwingBolt Lock Body

Works with these Lock Bodies also:



DeadBolt



SpringBolt



StrikeBolt

ScanLogic Optical – Biometric Safe Lock

The ScanLogic Optical is a very reliable and robust biometric safe lock system ideal for commercial applications.

The ScanLogic Optical features SecuRam's rugged stainless steel construction, and optical fingerprint authentication.

Simple to Use. Reliable.

- Place your registered finger on the optical reader and turn the safe handle. That's it.
- Easy fingerprint enrollment process; Open with fingerprint and/or code.
- ScanLogic Optical supports 30 fingerprints and 30 codes
- Every SecuRam lock undergoes a **2,000 cycle** quality management program before it leaves the manufacturing facility. Unprecedented commitment to quality and reliability.

Features

- Supports 30 fingerprints with our patented OneTouch fingerprint verification
- Supports hierarchical user management with Super, Manager, Supervisor and User Fingerprints/Codes
- Unique Self-Learning biometric function ensures easy operation
- Programmable Time Delay 0-99 minutes; 0-15 minute Time Window
- Can Control up to 4 locks and authorize user access for each lock
- 4,000+ openings on a 9 Volt battery (AC Power optional)
- Standard footprint and mounting pattern, easy retrofit for any mechanical or electronic safe lock
- Finishes available:
 - Chrome
 - Brass
 - Black Chrome
 - Nickel
- Can be paired with any other SecuRam motorized safe lock bodies.

Part#: FPC-0601A-II

Select your Lock Body:

SwingBolt	EL-0601
DeadBolt	EL-0701
SpringBolt	EL-0801
StrikeBolt	EL-0901

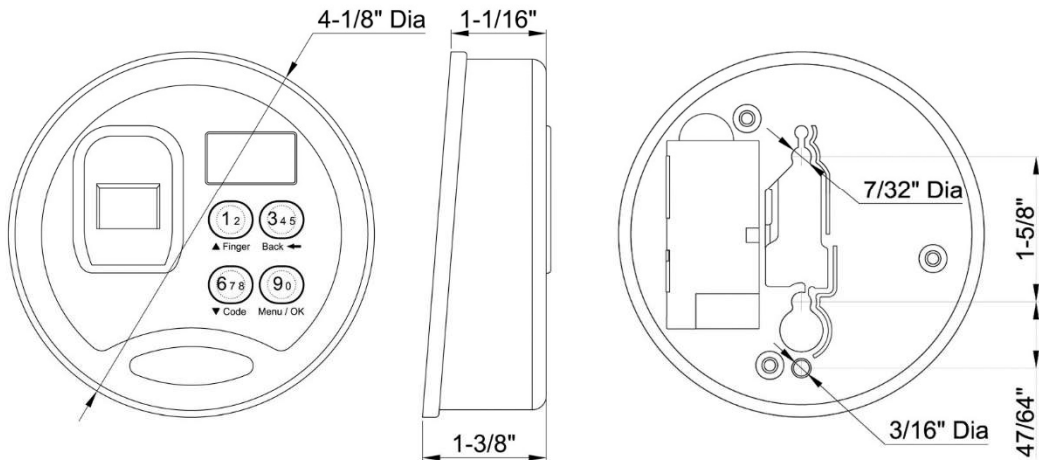

ScanLogic Part # FPC-0601A

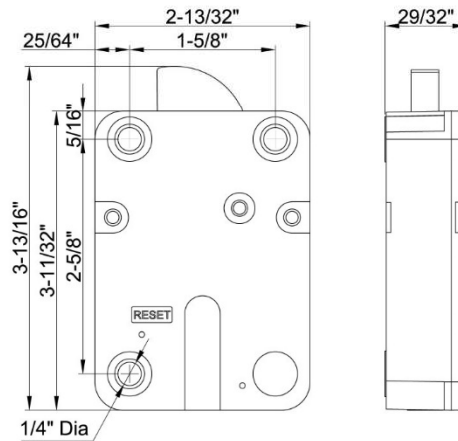

SwingBolt

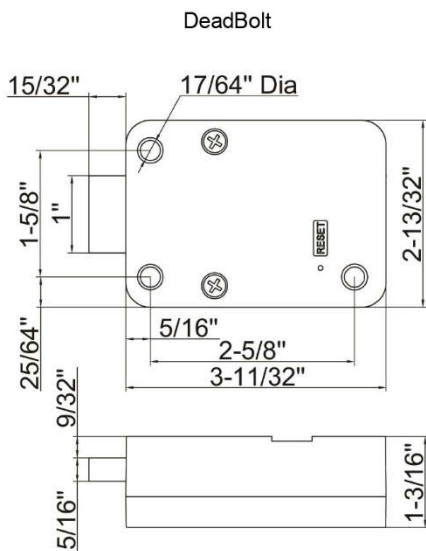

DeadBolt

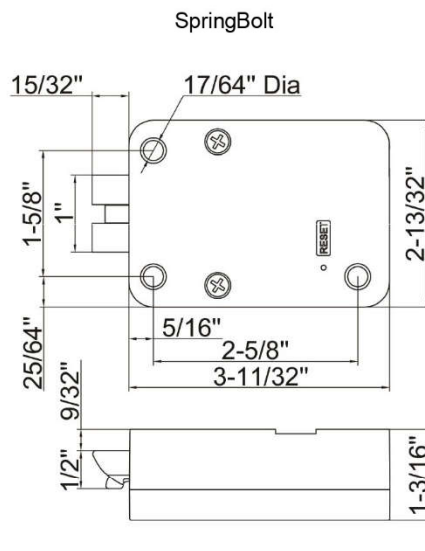

SpringBolt

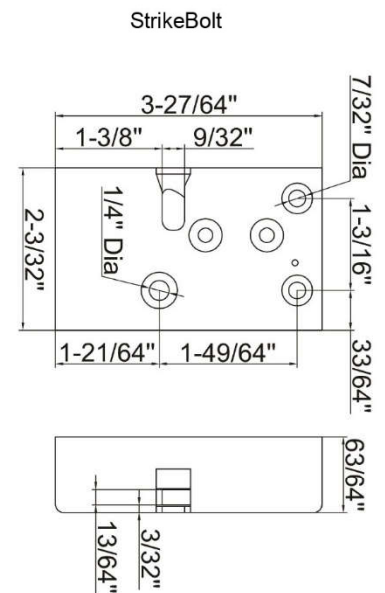

StrikeBolt

Specifications:

Registration Capacity	30 fingerprints + 30 passwords	Temperature Range	-4° F ~ 158° F (-20° C ~ 70° C)
Verification Time	< 1 second	False Acceptance Rate (FAR)	< 0.0001%
False Rejection Rate (FRR)	< 0.1%	Power Supply	(1) 9V Alkaline battery (Duracell)
Standby Current	< 50µA	Battery Life Span	2000~3000 operations
Operating Humidity	90% Maximum	Battery Low Voltage	5.4 ± 0.2V