

# SafeLogic BackLit

SecuRam. Reliable. Innovative. Trusted.

SECURITY



SafeLogic BackLit EntryPad



SureLock Battery Management



SwingBolt



DeadBolt



StrikeBolt



SpringBolt

SecuRam® is the registered trademark of SecuRam Systems Inc. USA

## SafeLogic BackLit Safe Lock

The SafeLogic BackLit is a very reliable and economical safe lock system ideal for most applications. The SafeLogic BackLit features SecuRam's rugged stainless steel construction. The EntryPad also features back lighting making access easy in dimly lit areas.

## Simple to Use. Reliable.

- Enter your code and turn the safe handle. That's it.
- Easy keypad programming allows for code changes, additions, and deletions. Enable and Disable function also.
- Battery Changes are simple. Pull down on SureLock Battery Compartment Lever and remove the compartment to change the 9 Volt battery. Then slide the SureLock back in place and lock the lever.
- Every SecuRam lock undergoes a **2,000 cycle** quality management program before it leaves the manufacturing facility. Unprecedented commitment to quality and reliability.

## Features

**Paired with Standard Lock Bodies\*** (EL-0601, EL-0701, EL-0801, EL-0901)

- 2 Codes: Manager Code and User Code

**Paired with "-D" Lock Bodies** (EL-0601-D, EL-0701-D, EL-0801-D)

- 3 Codes: Super Code, Manager Code, User Code
- 1 Reset Code
- Single or Dual Control
- Time Delay 0-40min; Time Window 1-20min

**Paired with -C10/C30 Lock Bodies**

(EL-0601-C10/30, EL-0701-C10/30, EL-0801-C10/30)

- 10/30 Codes: Super Code, Manager Code, 8/28 User Codes
- 1 Reset Code
- 8 Digit Codes
- Single or Dual Control
- Time Delay 0-40min; Time Window 1-20min

- EntryPad illuminates with the press of any button.
- Can be paired with any SecuRam motorized lock bodies.

## Part #: EC-0601A-BL-II

Select your Lock Body:

SwingBolt	EL-0601	EL-0601-D	EL-0601-C10	EL-0601-C30
DeadBolt	EL-0701	EL-0701-D	EL-0701-C10	EL-0701-C30
SpringBolt	EL-0801	EL-0801-D	EL-0801-C10	EL-0801-C30
StrikeBolt	EL-0901			

Security Expert Since 1991

**SecuRAM**

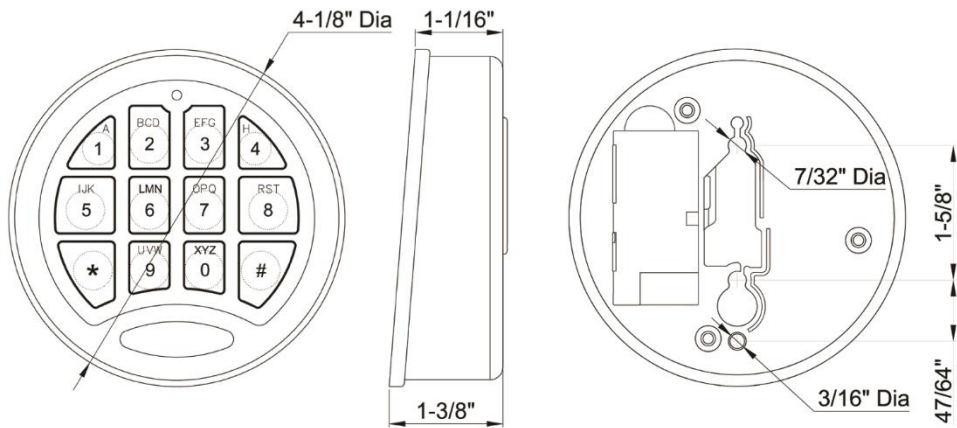

SafeLogic BackLit Part #EC-0601A-BL-II

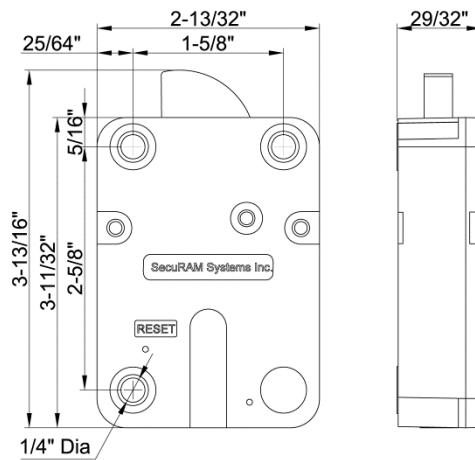

SwingBolt Part #EL-0601

DeadBolt Part #EL-0701

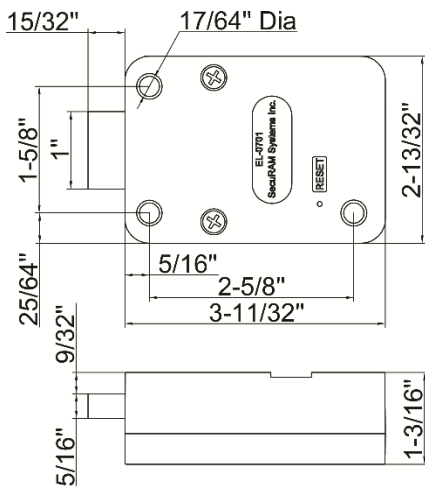

SpringBolt Part #EL-0801

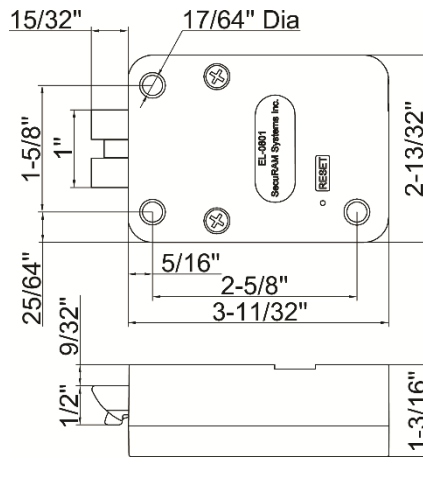

StrikeBolt Part #EL-0901

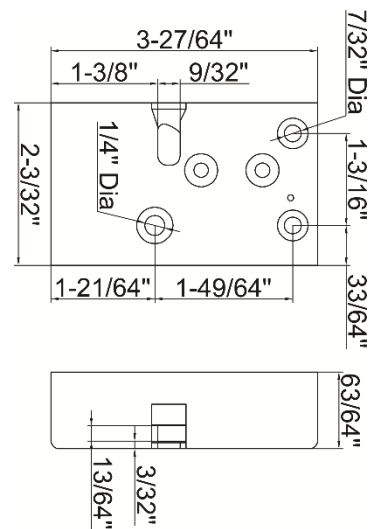

## Specifications

Power Supply	(1) 9V Alkaline Battery (Duracell)	Active Current	<20mA
Power Supply Range	DC 4.5V ~ 12V	Battery Low Voltage	5.2+/- 0.2V
Code Length	6 Digits	Temperature Range	32deg F to 120deg F
Standby Current	Specification<15uA	Operating Humidity	90% Maximum